

Drivtech SumoSprings

Variable Load Drivtech SumoSprings Kit

Part No: SS105V

Driver's side (Passenger's side similar)

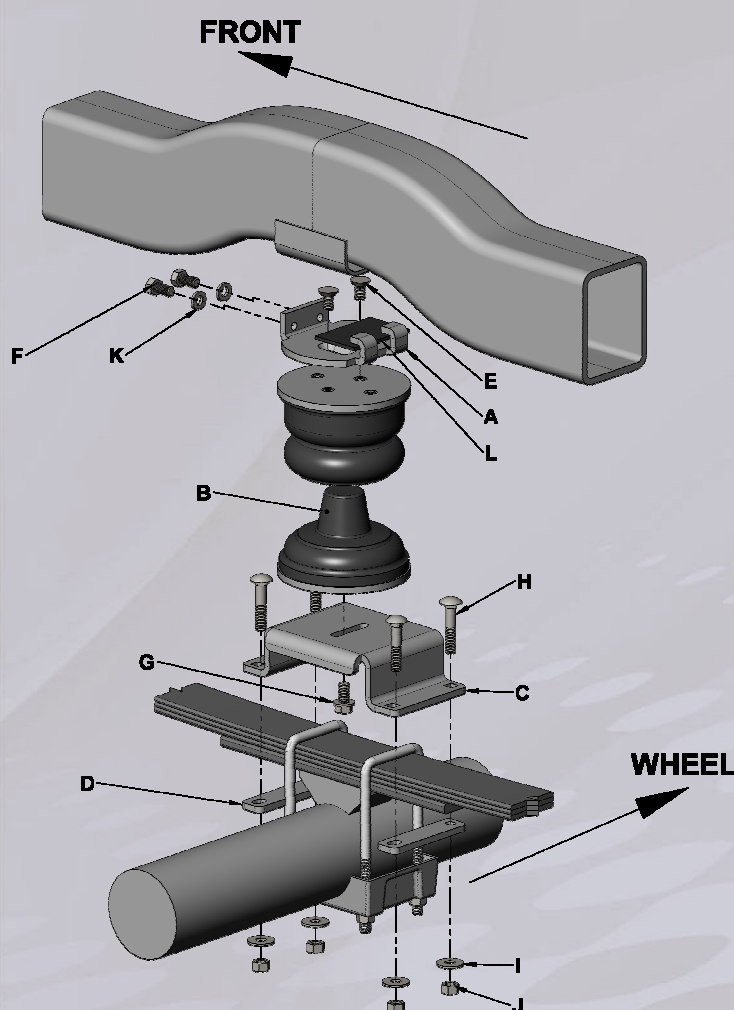

Parts List

Item	Part No	Description	Quantity
A	522023	Top bracket	2
B	521400	Drivtech SumoSprings	2
C	522033	Bottom bracket	2
D	522004	Bottom bracket strap	4
E	512245	3/8-16 x 7/8" FHCS	4
F	512223	3/8-16 x 1 1/2" hex bolt	4
G	512207	3/8-16 x 3/4" serrated flange hex bolt	2
H	512211	3/8-16 x 3 1/2" carriage bolts	8
I	512244	5/16" USS washers	8
J	512234	5/16-16 Top-lock nuts	8
K	512264	3/8" lock spring washers	4
L	112247	2" x 3" x 0.125" neoprene pad	2

Tool List

Description	Quantity
Floor Jack	1
Jack stands	2
Wheel wedges	4
9/16" spanner	1
9/16" socket and ratchet	1
1/2" spanner	1
5.5mm Allen Key	1

Important Notice

1. Read fitting instructions before attempting to install your Drivtech SumoSprings. Ensure you have all necessary tools available.
2. It is recommended that this installation be done by a Licensed Mechanic or persons with sound mechanical knowledge.
3. These instructions are designed as a guide for the installation of Drivtech SumoSprings. Motospecs accepts no liability for the actual installation process. All care should be taken when raising, lowering and working on vehicles. Installers should always apply common automotive safety practices.
4. Use ThreeBond 61305-10 anaerobic thread locker (or equivalent) where required to ensure Drivtech SumoSprings remain secure.
5. Drivtech SumoSprings are designed to enhance the vehicles load levelling performance and road handling. Motospecs does not recommend loading the vehicle beyond the manufacturer's GVM specifications.
6. If you are fitting Drivtech SumoSprings to a raised vehicle you will need to use the optional spacer blocks. Consult your original place of purchase for more information.
7. Observe all safety precautions and wear safety glasses.



Installation Instructions

1. Park vehicle on a hard level surface.
2. Place wheel wedges in front and behind the front wheels to prevent rolling.
3. Raise the rear of the vehicle allowing the axle to hang free and rest the chassis on jack stands rated for the weight of the vehicle.
4. Removal of the rear wheels is optional, however it is recommended.
5. Starting with the driver's side. Loosen the U-Bolts and remove the factory bump stops. Re-tension the U-Bolts to Manufacturers specifications.
6. Position a neoprene pad (Item L) towards the rear of the bump stop striker plate.
7. Attach top bracket (Item A) to the cup section of the spring (Item B) as in the exploded view.
8. Loosely assemble the lower bracket (Item C) to the cone section of the spring (Item B) with a 3/8-16 x 3/4" serrated flange hex bolt (Item G).
9. Lift the upper assembly up hooking the folded tabs into the rear of the bump stop striker plate.
10. Lifting the front of the bracket up tighten the two 3/8-16 x 1 1/2" hex bolts (Item F) and 3/8" lock spring washers (Item K) until they are resting flush against the top bracket (Item A).
11. Jack up the axle so that the bottom bracket (Item C) is sitting firmly on the leaf pack and the cup and cone section of the spring (Item B) have come together. Ensure the offset of the spring is towards the diff centre.
12. Attach the bottom bracket to the factory spring-pack by placing two bottom bracket straps (Item D) under the factory spring-pack and bolting the lower assembly together using four 3/8-16x3 1/2" carriage bolts (Item H) and four 5/16" USS washer's (Item I) and four 3/8-16 top-lock nuts (Item J).
13. Ensure optimum alignment of the spring has been achieved before tightening the 3/8-16 x 3/4" serrated flange hex bolt (Item G).
14. Repeat steps four through to fourteen on the passengers side of the vehicle.
15. Jack up vehicle, remove safety jack stands. Carefully lower vehicle.
16. Remove wheel wedges from the front wheels.

To prevent damage to the vehicle and to ensure safety, do not exceed the Gross Vehicle Mass recommended by the vehicles manufacturer (GVM).



Drivetech SumoSprings Express Warranty

Your Drivetech SumoSprings load levelling kit is covered by the Express Warranty set out in this warranty statement. The Drivetech SumoSprings load levelling kit is warranted to be free of defects in material and workmanship for a period of 2 years/40,000kms from the date of purchase. If a defect in material or workmanship arises during this period, Motospecs will at our option repair or replace the Drivetech SumoSprings load levelling kit.

In order to make a claim under this warranty, you must return the faulty Goods to your original place of purchase together with proof of purchase.

What is not covered by this Express Warranty?

- This Express Warranty does not cover:
- Damage arising or related to any vehicle, product, or component combination other than the Drivetech SumoSprings load levelling kit
- Improper use of your vehicle, including overloading
- Normal wear and tear, deterioration of spring shape or rating, alteration or failure to maintain
- Scratches or defects in product finishes (powder coating, paint, etc)
- Racing or other vehicle competitions or contests
- Accidents, impact by rocks, trees, obstacles or other aspects of the environment

This Express Warranty does not cover the costs of removal, shipping or installation. Our goods come with guarantees that cannot be excluded under the Australian Consumer Law. You are entitled to a replacement or refund for a major failure and for compensation for any other reasonably foreseeable loss or damage. You are also entitled to have the goods repaired or replaced if the goods fail to be of acceptable quality and the failure does not amount to a major failure.

Australia – 1800 463 646

www.sumosprings.com.au

New Zealand – 0800 809 808

www.sumosprings.co.nz